

**SPRING  
TERMINAL BLOCK**

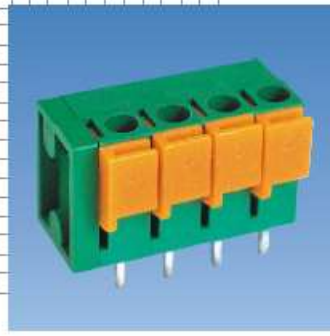

**TYPE STB851**



**SPECIFICATIONS**

WIRE ENTRANCE: .....Vertical to PCB	WIRE PROTECTOR: .....Steel, Ni Plated
CENTER SPACING: ..... 5.00mm / 0.197 in	TERMINAL: .....Brass, Tin Plated
WIRE RANGE: .....14--22AWG	TEMPERATURE:
ELECTRICAL RATING: .....300V, 10A	OPERATING:.....-40°C to +105°C
BREAKDOWN VOLTAGE: .....4,000V	-40 °C to +221°C
MOLDING: .....Polyamide, UL94, V-0 Self Extinguishing	MAX.SOLDERING:.....260°C , +500° F for 5 seconds

**MECHANICAL DIMENSIONS**

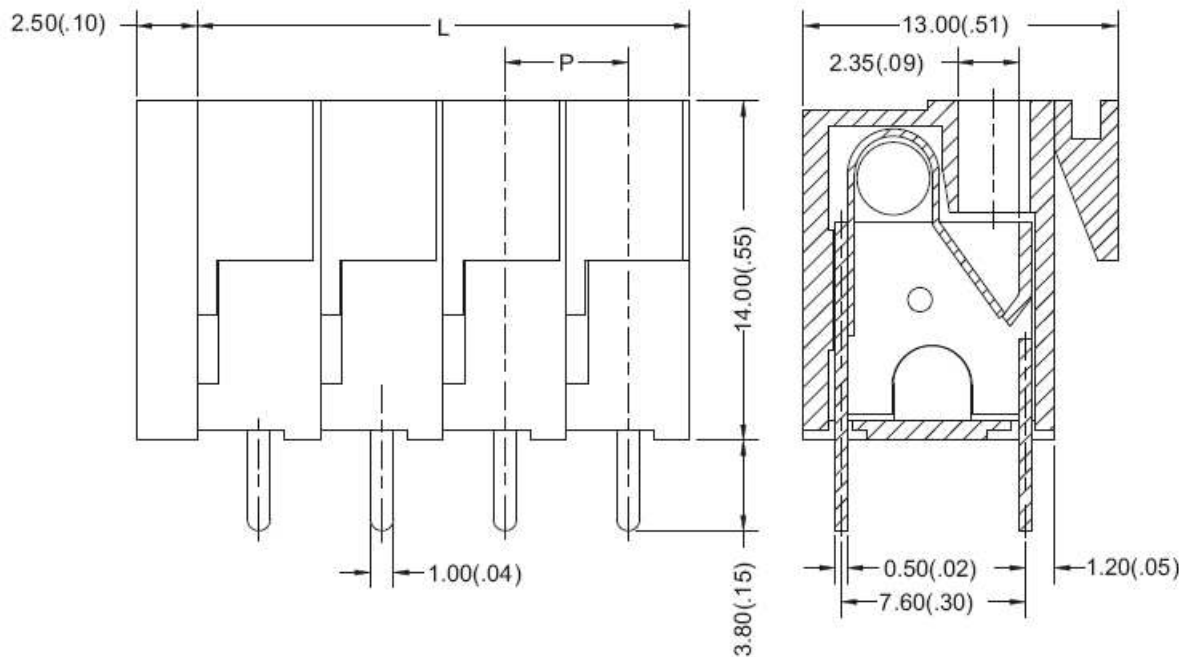

P = Center to Center Spacing  
 Length of Connector (L)  
 L = number of Poles X Center Spacing  
 Dimensions: mm (in.)

**ORDERING INFORMATION**

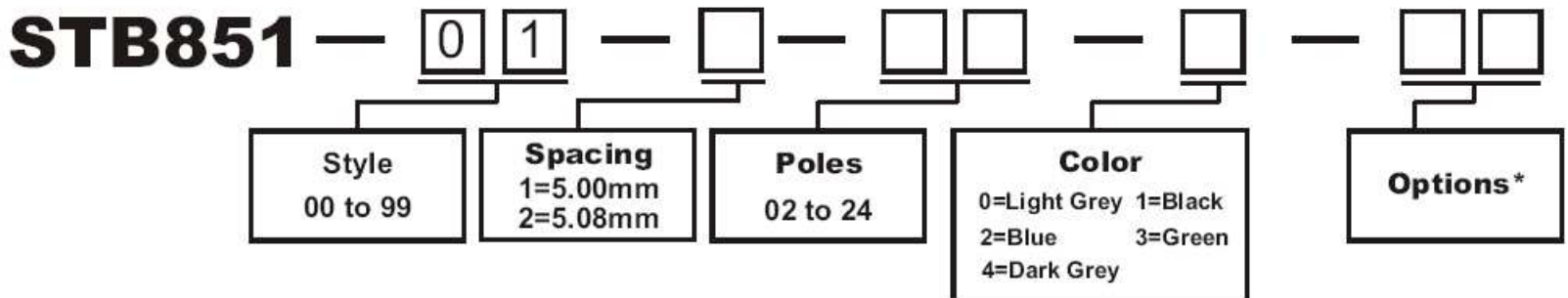

**Options\*:** M1~M9, For Customer Modification (Please provide sketch).  
 If more than one option is required, please separate each option with a dash (-).