

**PLUGGABLE
TERMINAL BLOCK**

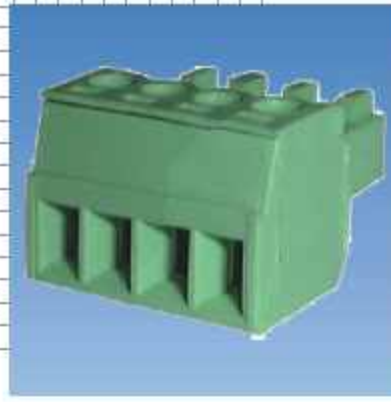

TYPE PTB350B



SPECIFICATIONS

WIRE ENTRANCE:Parallel to PCB	WIRE PROTECTOR:.....Bronze, Ni Plated
CENTER SPACING:3.50mm / 0.138in.	SCREW: M2, Philips Steel, Zinc Plated
WIRE RANGE:16--24 AWG	WIRE CAGE:..... Brass, Ni Plated
ELECTRICAL RATING:300V, 8A	OPERATING:-40°C to +105°C -40°F to + 221°F
BREAKDOWN VOLTAGE:4,000V	MAX. SOLDERING:260°C , +500°F for 5 seconds
MOLDING:Polyamide, UL94, V-0 Self Extinguishing	
MAX. TORQUE:.....2 lb-in.	

MECHANICAL DIMENSIONS

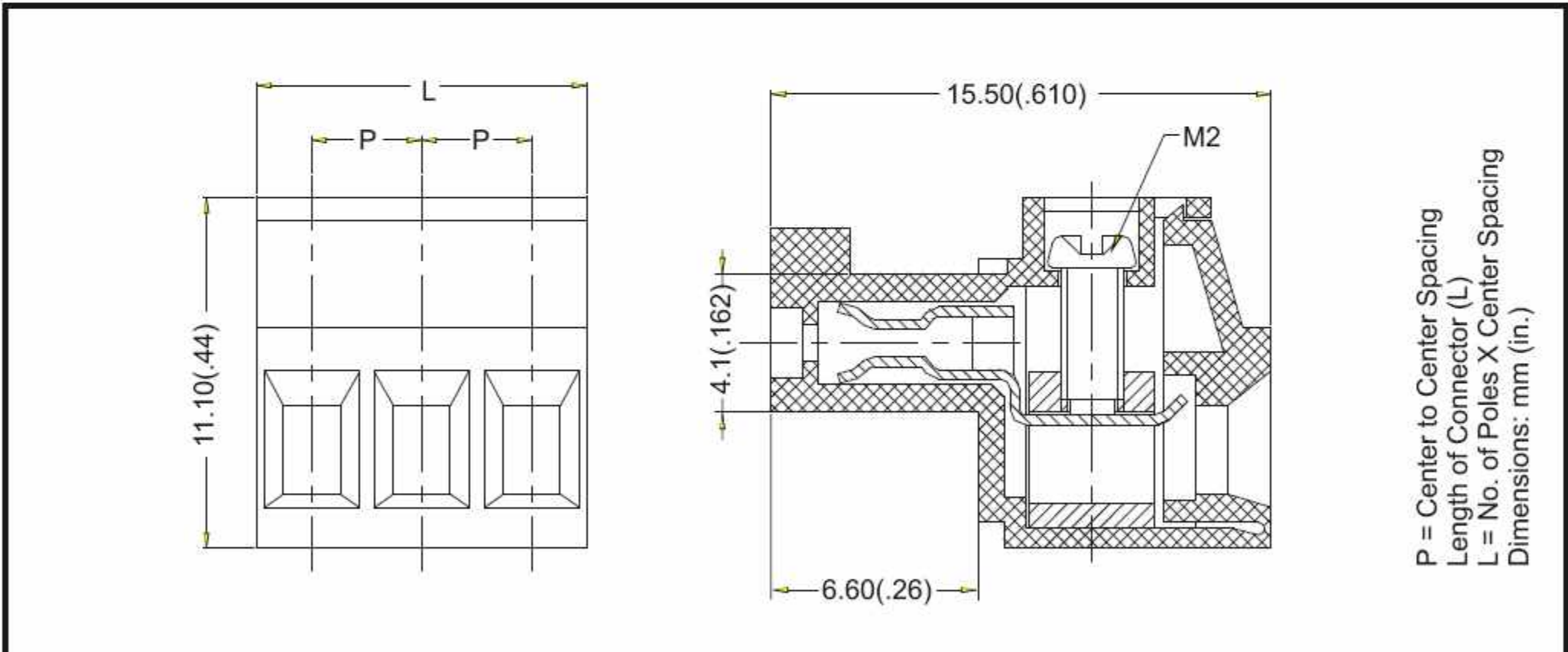

ORDERING INFORMATION

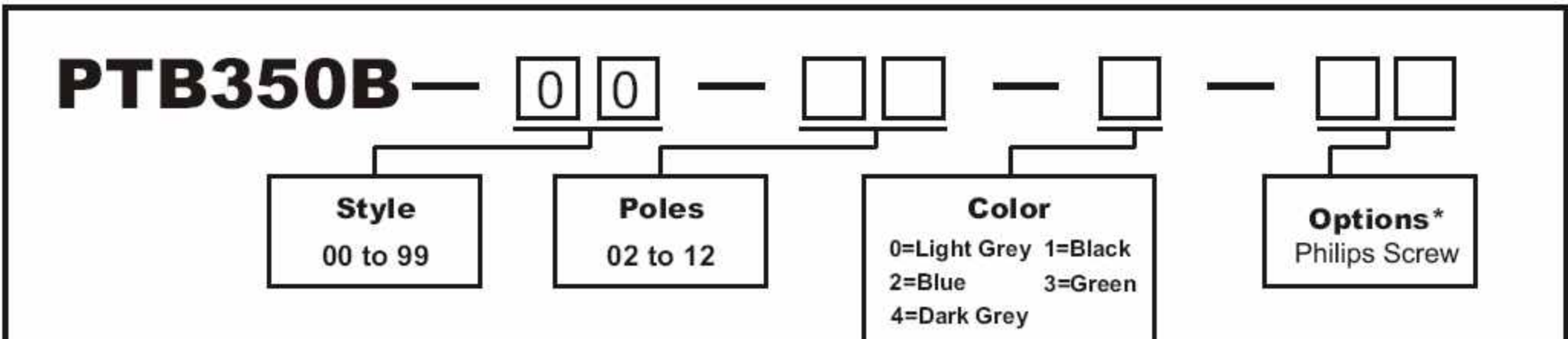

Options*: M1~M9, For Customer Modification (Please provide sketch).
If more than one option is required, please separate each option with a dash (-).