

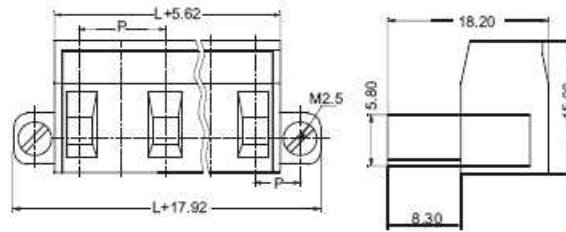

## PTB750B-04-5



P=Pitch  
L=(n-1) x P  
N=NO. Of Poles

### TECHNICAL DATA

W: E183240 ©: 201660

PITCH	7.62mm
WIRE RANGE	30--12AWG
MAX. TORQUE	5lb-in.
ELECTRICAL RATING	300V, 15A
BREAKDOWN VOLTAGE	4,000V
PEEL LENGTH	6.50mm

### MATERIALS

BODY	PA66,UL94,V-0
SCREW	M3,Steel,Zinc Plated
WIRE PROTECTOR	Tin Bronze,Tin Plated
WIRE CAGE	Brass,Nickel Plated
OPERATING	-40°C ~ +105°C

MATE WITH HEADER: **PTB750S-04-5**

Poles	L	Poles	L
02	7.62	18	129.54
03	15.24	19	137.16
04	22.86	20	144.78
05	30.48	21	152.40
06	38.10	22	160.02
07	45.72	23	167.64
08	53.34	24	175.26
09	60.96		
10	68.58		
11	76.20		
12	83.82		
13	91.44		
14	99.06		
15	106.68		
16	114.30		
17	121.92		

## ORDERING INFORMATION

PTB750B —   —  —   —  — M

00 to 99

1=5.00mm  
2=5.08mm  
3=6.35mm  
4=7.50mm  
5=7.62mm

02 to 24

Color	
0=Light Grey	1=Black
2=Blue	3=Green
4=Dark Grey	